

M8 Adapter

M8 Male-Female Panel Mount

Male

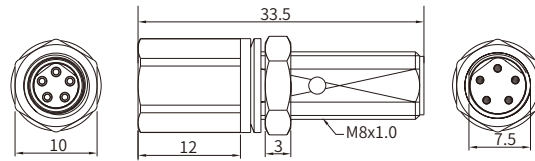

Specifications

Contacts	3 (A-coding)	4 (A-coding)	5 (B-coding)
Pin layout(Male)			
Pin layout(Female)			
Standard	IEC 61076-2-104		
Ambient temperature	-25°C ~ +90°C		
Connector insert	TPU / PA+GF		
Connector contacts	Brass with gold plated		
Coupling nut/screw	Brass with nickel plated		
Seal/O-ring	Epoxy resin / FKM		
Insulation resistance	≥100MΩ		
Contact resistance	≤5mΩ		
Shielding	Unavailable		
IP rating	IP67 in locked condition		
Mating endurance	>500 cycles		
Rated current	3 A		
Rated voltage	50V AC/60V DC		30V AC / DC
Panel cut-out	Refer to page 101		

Part Number

Pins	Male-Female
3	MT-004
4	MT-005
5	MT-006